

Diaphragm Seal Type Pressure Gauge

Model No. **SS-3033/6 Series**

KINS



SS-3033

Summary

This gauge is designed to guarantee the performance and the life span when measuring pressure in chemical industry even when measuring fluid is mixed with powder which has coagulation or strong corrosiveness.

Safety Management

- Be sure to install a protecting device where exist abrupt change of pressure, vibration and pulsation.
- Do not give impact during the transportation, installation and usage.
- Be sure to install pressure gauge to be horizontal and vertical.

Purpose of Use

- Corrosive fluid such as petrochemistry, etc.
- Fluid which is mixed with dust and solid matter in the plant of cement, papers, etc.
- High temperature, high viscosity fluid, special fluid line for industrial use, etc.

Production Specification

- ▶ **Diameter**
 - 100 mm
- ▶ **Accuracy**
 - $\pm 1.0\%$ of Full Scale
- ▶ **Scale Range**
 - $-0.1 \text{ MPa} \sim 0$, $-0.1 \text{ MPa} \sim 2 \text{ MPa}$, $0 \sim 10 \text{ MPa}$
 - (※ $1 \text{ MPa} = 10.19716 \text{ kgf/cm}^2$)
- ▶ **Working Pressure**
 - Static pressure : 75% of Full Scale
 - Fluctuating pressure : 60% of Full Scale
- ▶ **Working Temperature**
 - Ambient : $-20 \sim 65 \text{ }^{\circ}\text{C}$
 - Fluid : $-20 \sim 80 \text{ }^{\circ}\text{C}$

Product Specification

+ Case & Cover <ul style="list-style-type: none"> · STS 304 	+ Type <ul style="list-style-type: none"> · SS-3033-Type (Direct – flange) · SS-3036-Type (Flexible – flange) 	+ Movement <ul style="list-style-type: none"> · STS 304
+ Upper Flange <ul style="list-style-type: none"> · STS 304, STS 316 	+ Pointer <ul style="list-style-type: none"> · Aluminum · Black coating 	+ Element <ul style="list-style-type: none"> · STS 304, STS 316 · C type bourdon tube
+ Under Flange <ul style="list-style-type: none"> · STS 304, STS 316 · See flange standard table 	+ Dial <ul style="list-style-type: none"> · Aluminum · White color coating · Black gradation and characters 	+ Diaphragm <ul style="list-style-type: none"> · STS 304, STS 316 · Teflon(Lining, Coating), Titanium · Able to produce teflon(lining, coating)titanium, tantalum, hastelloy, etc
+ Window <ul style="list-style-type: none"> · Tempered safety glass, · Laminated safety glass 		

Diaphragm Seal Type Pressure Gauge

Model No. **SS-3033/6 Series**

Model No. | SS-3033 (100mm) A-Type (Rimless type), Direct Type

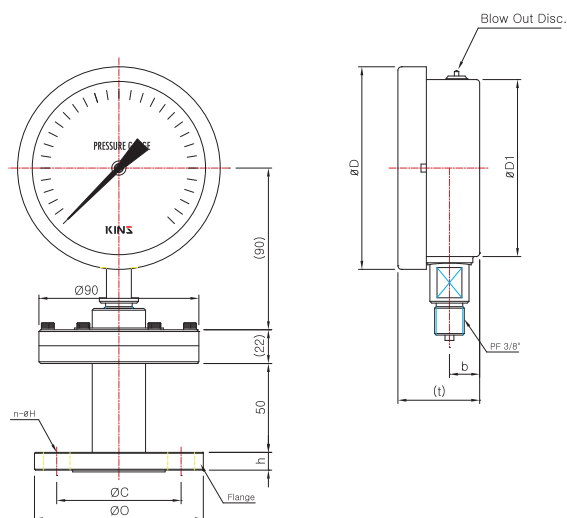

Model No. | SS-3036 (100mm) B-Type (Surface type), Remote Type

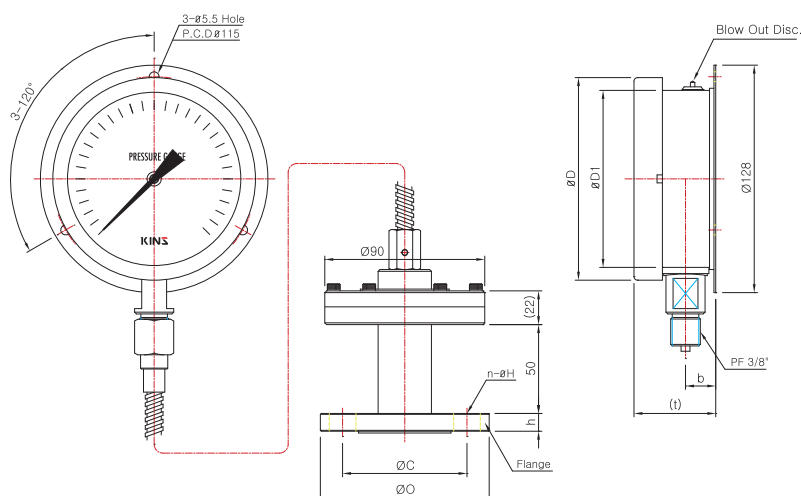

Dimensions (mm)

Model No.	ØD	ØD1	b	t	JIS 10kgf/cm ²	ØO	ØC	n-ØH	h	ANSI CLASS #150	ØO	ØC	n-ØH	h
SS-3033 & SS-3036	114	100	17	(46)	15A	95	70	4-Ø15	12	1/2B	89	60.3	4-Ø16	11.5
					20A	100	75	4-Ø15	14	3/4B	98	69.9	4-Ø16	13.0
					25A	125	90	4-Ø19	14	1B	108	79.4	4-Ø16	14.5
					32A	135	100	4-Ø19	16	1 1/4B	117	88.9	4-Ø16	16.0
					40A	140	105	4-Ø19	16	1 1/2B	127	98.4	4-Ø16	17.5
					50A	155	120	4-Ø19	16	2B	152	120.6	4-Ø19	19.5

*()The measurement in the blanket is approximate.